

# 4L60E-ABUSE-BP

## Repeated 3-4 Clutch Failure? Flare 2-3 Hot?



There are many causes for 3-4 clutch burn-up besides a loose input shaft. Here's another one that is well hidden..

A **loose divider plug** between the Reverse Abuse valve spring and the 3-2 downshift valve can leak enough 3rd oil pressure to cause the 3-4 clutch to slip. It can also show up as a flare on the 2-3 shift hot.

This divider plug leak is **downstream** from the 3rd feed orifice that feeds the 3-4 clutch. A combination of small leaks in the pump/drum/rings or here can add up to a significant drop in pressure because **they are all AFTER** the 3rd feed orifice. This type of leak becomes worse the hotter the fluid becomes.

**Step 1** Remove 3-2 Downshift Valve assembly to access & discard **original divider plug**. Save the roll pin for reuse.

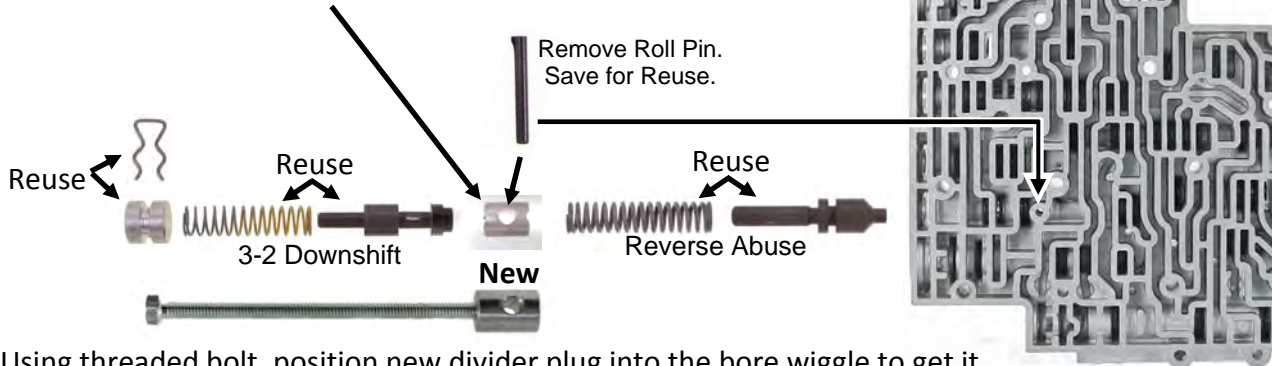

**Step 2** Using threaded bolt, position new divider plug into the bore wiggle to get it started straight & making sure it installs deep enough for original roll pin to insert thru the hole in the new plug. Remove threaded bolt and reassemble 3-2 downshift valve.